



## NAVIGARE CHARTER FLEET 2019 Annex 1- OCEANIS YACHT 62 - MED

### SPECIFICATIONS

(all prices in Euro ex VAT.)

LOA (meter)	19,07
Beam (meter)	5,33
Draft (meter)	2,30
Light Displacement (kg)	24 200
Engine (Hp)	160
Sail area main & furling genoa (m <sup>2</sup> )	156
Cabins	4+1
Toilettes	2+1
Steering wheels	2
Registered number of guests (RNOG)	8+2+1
Diesel tank (liter)	1 000
Water tank (liter)	1 060

### OCEANIS YACHT 62



*Non contractual image. Illustrations may feature optional equipment available at additional cost.*



Commissioning - Delivery &  
Registration included



## OCEANIS YACHT 62

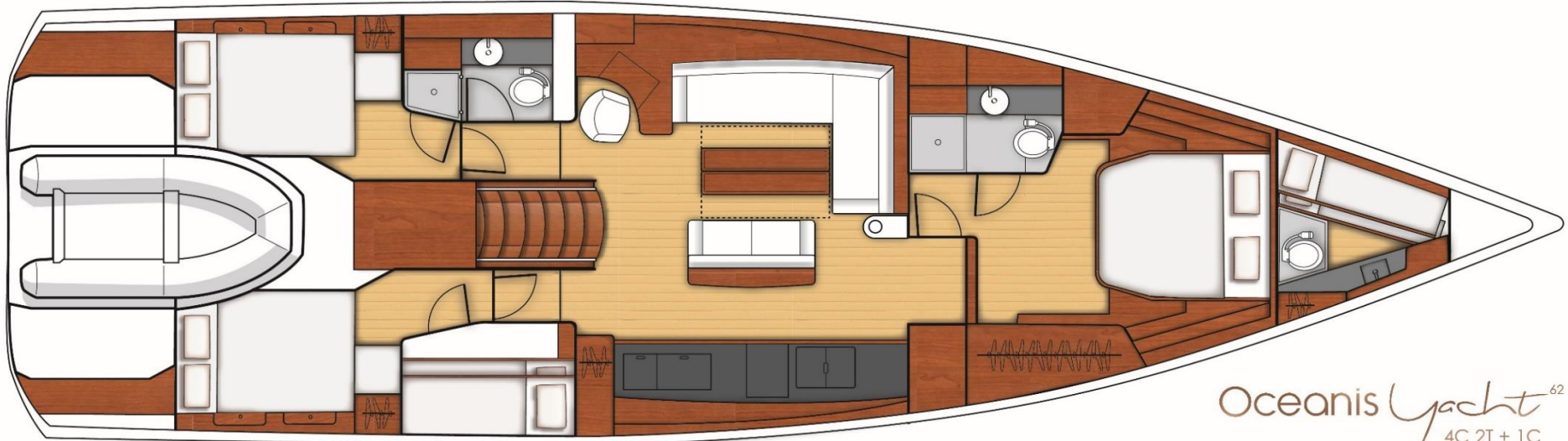

Oceanis Yacht<sup>62</sup>  
4C 2T + 1C

*Non contractual image. Illustrations may feature optional equipment available at additional cost.*



### STANDARD EQUIPMENT

Pullpit & pushpit  
 Rail openings midships x 2  
 8 mooring cleats  
 2 ST electric genoa sheet winches 70.2 STC  
 1 Starboard manual manoeuvre winch - 46.2 STC  
 1 Port electric primary winch (H50.2 STECH)  
 Electric windlass  
 Electric and manual bilge pump  
 Navigational lights and deck light  
 Cockpitable  
 Cockpit shower  
 Swimming ladder  
 Steering pedestal & wheel x2  
 Teak on cockpit seats & floor  
 Emergency tiller  
 Dacron furling genoa  
 Full batten dacron mainsail with Beneteau logo  
 Tensioners and lines led to the cockpit  
 Engine: 160Hp Yanmar, shaft drive  
 Water cooling with sea water filter  
 Engine hours counter & rev-counter  
 Insulated engine compartment  
 Diesel tank with level indicator & filter  
 Compass  
 Holding tank disposal via seacock for each head  
 AC-shore supply  
 Power supply switchboard, nav area  
 Voltmeter  
 Battery engine 12V 140Ah  
 12V, 25 A engine battery charger  
 24V, 280 Ah service battery set (4x12V, 140 Ah)  
 24 V - 60 A engine battery charger  
 AC & DC-socket at switch board  
 Electric fresh water pump  
 Water heater

U-shaped galley  
 Corian worktop  
 Rectangular stainless steel sink  
 Gas cooker 3 burners, S/S steel grill and oven swivels

### OPTIONS INCLUDED

4 CABINS 2 HEADS VERSION - WALNUT ALPI  
 STEM CABIN - ALPI WALNUT ALPI  
 MACADAMIA UPHOLSTERY IN SALOON  
 ANODISED FURLING MAST W HYDRANET GENOA & MAIN SAIL  
 PORT REWIND ROPE HANDLING WINCH - H46.2STECH  
 ELECTRIC STARBOARD COACHROOF WINCH H50.2STCEH  
 CHARCOAL PIQUE COACHROOF SPRAYHOOD  
 ACCOMODATION LADDERS  
 LUXE COCKPIT BIMINI - CHARCOAL PIQUE  
 TENDER LOADING SYSTEM  
 DIAMANTE SNOW OUTSIDE UPHOLSTERY  
 DIAMANTE SNOW FORWARD SUN MATTRESS  
 STERN THRUSTER  
 ELECTRIC SEA WATER PUMP IN THE GALLEY  
 GENERATOR 17,5KVA - 230V50HZ - WITH COCOON  
 4 UNDERWATER PROJECTORS  
 LED SPREADER LIGHTING (ANODISED MAST)  
 FRIDGE, 2 DRAWERS, 144L / 38 US GAL  
 DISHWASHER (6 SETS) 230V  
 CHILLED WATER AIR CONDITIONING - 42000 BTU  
 CHEST OF DRAWERS IN FORWARD CABIN  
 INVERTER 24-230V50 2KVA  
 40"TV + FUSION PLAYER IN SALOON  
 AIS 500 B&G  
 FIXED V90 VHF, AIS RECEIVER + 2 H50 HANDSETS  
 SOLID WOOD SLATTED CATWALKS

### PACKS INCLUDED

**ELECTRONIC PACK A, B&G**  
 Port and starboard helm stations:  
 1 GRP pod for navigation instruments on stainless steel leg,  
 2 built-in stainless steel handrails  
 1 Zeus 12" multifunction wide wireless screen (GPS, Chart plotter,  
 Chart reader - Navionics Silver cartography included)  
 1 Graphic display H5000 display  
 H5000 unit (Vessel Management Unit, Log, Speedometer, Temperature,  
 Windvane, Anenometer)  
 PC interface

### PILOTE PACK

B&G Autopilot, Control at steering station  
 WR10 Wireless autopilot remote control

NAVIGARE YACHTING  
EXPERIENCE TOGETHER



## NAVIGARE EQUIPMENT

### Windex

Antifouling with double epoxy treatment  
First filling & engine service  
Spare fuel cannister, 5 liter

Mooringrope 2\*15 m, 2\*20 m & 1\*50 m

Fenders \* 8

Baloon fender

Gangway

DELTA anchor & Anchor connector

Anchor chain 100 meter

Anchor thief

Hook for releaving anchor windlass + 4m rope

Second anchor & 10 + 2 m chain w. Schackles.

Boat hook

Power cord for shore supply (30 m)

Life raft. (RNOG)

Horse shoe life bouy, holder & light

Rescue sling (Life sling)

Emergency flares

Fire extinguishers

Wire cutter

Safety harnesses + rope with hooks (RNOG / 2)

Lifewest (RNOG + 1 junior)

Radar reflector

Wooden plugs

Fog horn

First aid kit

Seacharts (full set)

Navigational equipment (traveller, ruler, pen etc.)

Binoculars

Loggbok

Local waters pilot

Barometer and watch

Nationality flag + Navigare flag

Signal flags

Torch (flash light) w. spare batteries

Flashlight 12 volt

Mask, snorkel and fins

Bosun`s chair

Spares; engine oil, 3 \* filter, engine belt & impeller

Toolbox with tools

Galley and cooking equipment

Glas, wine glas & cups (RNOG)

Knives, forks and spoons (RNOG)

Plates - big, small and deep (RNOG)

Gasol bottles \* 2

Sheets, pillowcases, towels & kitchen towels (RNOG)

Blankets and pillows (RNOG)

Hangers (cabins x 6)

Water hose 15 m, with watergun

Deck brush and bucket

Toilet brush (nr of WC)

Dustbin (nr of WC)

Cleaing equipment (interior)

Funnel, Sponge and container

Navigare wifi system 3G/4G