



NAVIGARE CHARTER FLEET 2019

Annex 1- SAONA 47 QUINTET - BVI

SPECIFICATIONS

LOA (meter)
Beam (meter)
Draft (meter)
Light Displacement (kg)
Engine (Hp)
Sail area main & furling genoa (m²)
Cabins
Toilettes
Steering wheels
Registered number of guests (RNOG)
Diesel tank (liter)
Water tank (liter)

SAONA 47 QUINTET

13,94
7,70
1,30
13 800
2 x 60
127
5+1
5
1
10+1+1
700
940

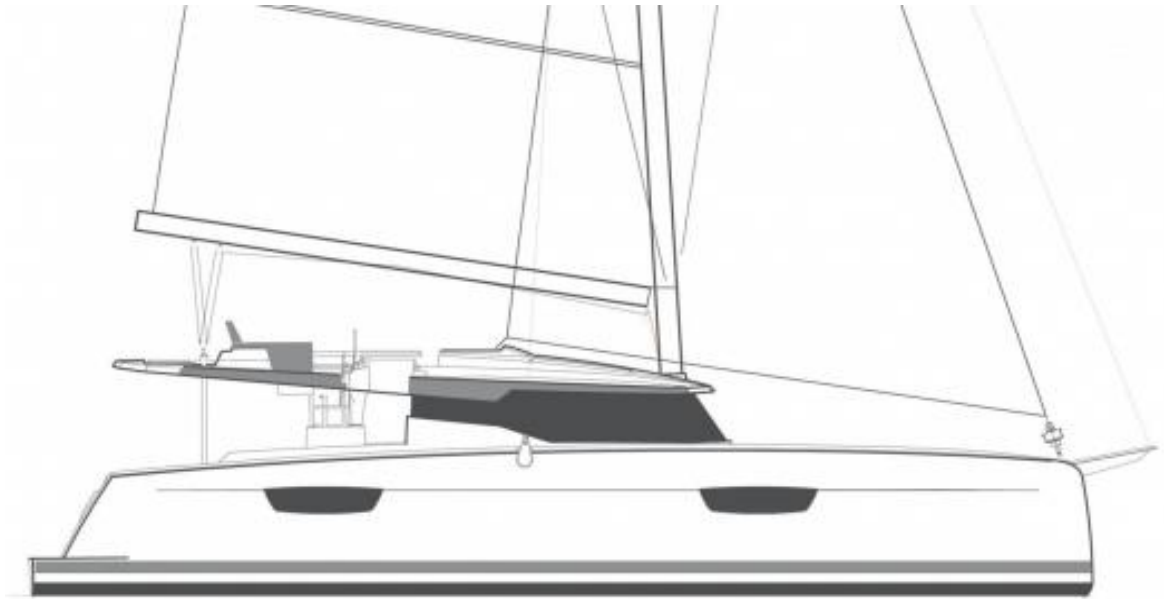

Non contractual image. Illustrations may feature optional equipment available at additional cost.

Commissioning - Cargo ship Delivery &
Registration included



SAONA 47 QUINTET

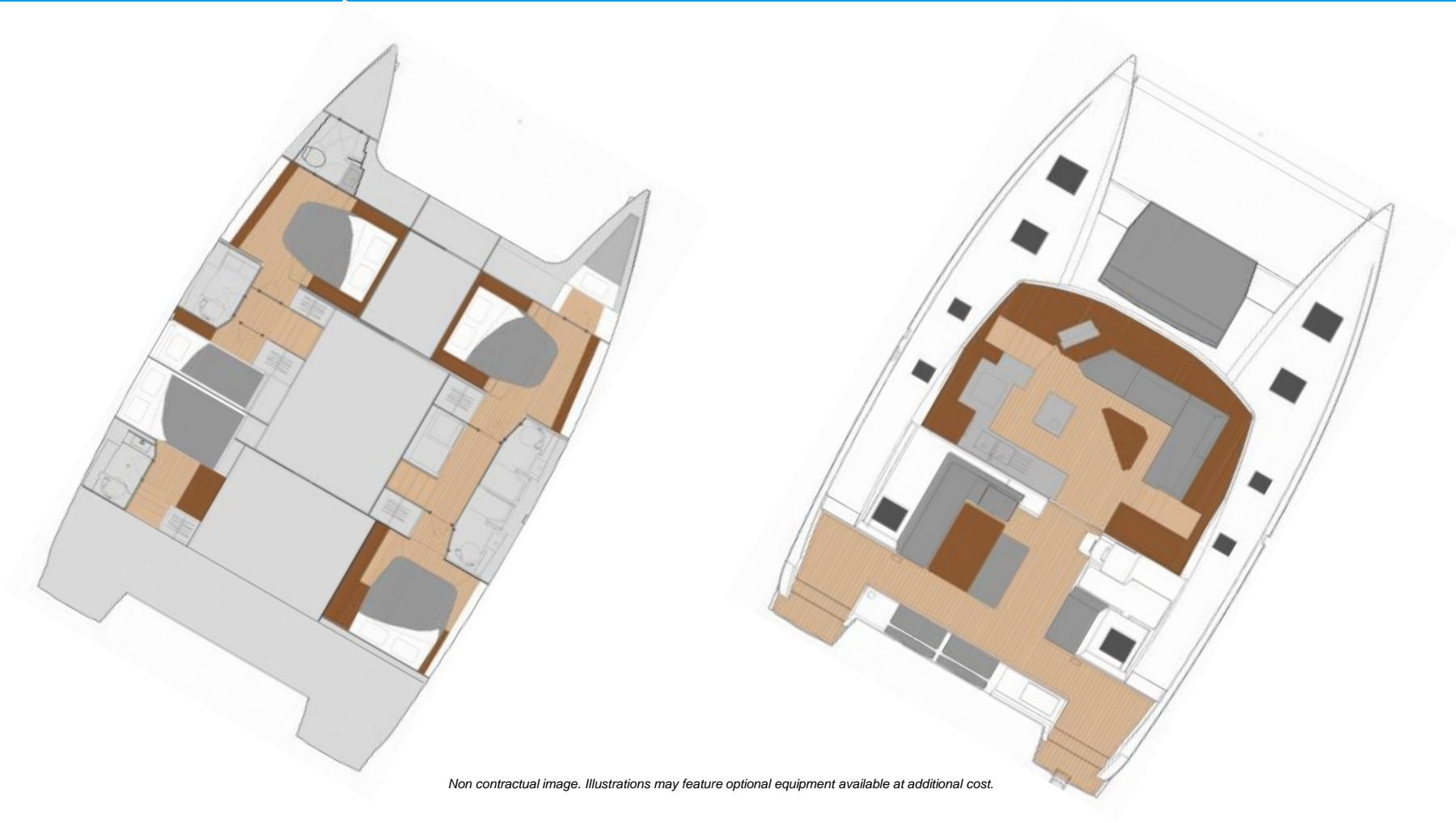

Non contractual image. Illustrations may feature optional equipment available at additional cost.



YARD EQUIPMENT

STANDARD EQUIPMENT

Alpi woodworking
 Salon / Cabins flooring : Timber-laid floor
 Resin worktop
 1 x 4 burner stove with pan holder, stainless gas oven
 2 stainless steel sinks
 Pressurised hot and cold fresh water by mixer tap
 2 large cupboards under the sinks
 190L cold storage volume (12V) in central "island" kitchen unit
 1 large storage cupboard on the starboard side of the entrance
 Holding tanks for all heads
 Electric drainage pump
 Mixing valve tap for shower
 Manual marine toilet
 1 Bench seat
 1 teak cockpit table for 8 persons
 Helmsman seat for 3 persons
 Stair to access to the fly bridge
 2 fixed blades propellers
 Complete engine panel and dual controls at helm station
 1 Fuel tank with filling by plug hole on deck
 2 x fresh water tanks with electric gauge
 1 electric pump and pressure accumulator
 1 x 60L water-heater
 1 electric bilge pump (2m3/h) in each engine room
 1 electric pump (2m3/h) in each hull.
 1 manual exterior bilge pump
 2 x 115A/12V engine alternators
 1 set starboard onboard/engine batteries of 600A/h (4 x 150 Ah)
 1 port engine battery of 50A/h/ 800CCA
 1 V.H.F. antenna at the top of the mast
 Mast and boom in anodised aluminium
 Ball bearing mainsail luff car
 1 genoa & 1 spinnaker halyard

Clutches on all halyards for genoa, spinnaker and topping lift
 Navigation, running and mooring lights
 Deck lighting
 Full batten CSR mainsail
 Roller genoa fuller
 1 ball bearing traveller for mainsheet
 - 2 x tackle on mainsheet traveller clutches on roof
 - 2 x genoa tracks with load block
 - 2 genoa sheets
 - 2 x size 50 ST winches for main halyard, sheet & reef
 1 size 55 self tailing winch for genoa sheet

OPTIONS INCLUDED

2 VOLVO 60HP D2 engines
 Taupe Pvc outdoor upholstery
 Taupe Pvc indoor upholstery
 Polyester cockpit table
 Bimini for helm station
 Outdoor cushions (cockpit + lounge deck)
 Outdoor foredeck cushions
 Saloon curtains
 Synthetic Teak floor on transoms & cockpit
 Fitting out stbd peak
 Saloon table convertible into bed
 12V 130L Fridge
 Cockpit fridge
 Electric head large bowl x5
 12V fan x 6
 Cockpit courtesy lighting
 Underwater lighting 2x21 W
 Additional AGM battery 150A suppl.
 1 Electric winch for genoa sheet
 Electric davit winch

OPTIONS INCLUDED cont.

Interior 12V outlet
 Second VHF AIS helmstation
 110V Water heater
 110V main grid 110V 60HZ
 2000W Inverter/charger / 110V 60HZ
 12KW 110V 60HZ genset
 Aircon 110V 60HZ main syst. 40K BTU Quintet

PACKS INCLUDED

OCEANIC VERSION

Curtains in cabins
 Mooring kit + 4 fenders
 CST mainsail full batten
 Automatic mainsail hook
 Lazy jack
 Electrical windlass (1500 Watts)
 VHF mast head antenna prewired
 Double clutche for reefs 2 and 3
 Interior 12V outlet and waterproof exterior 12V outlet
 Deck shower (cold water)
 Auto. switch for bilge pumps
 Lazy bag
 Dralon protective cover for wheel
 1 Electric winch for mainsail
 Interior courtesy LED lighting
 Pressurized seawater system
 Fusion audio pack Bluetooth 4 Sp.
 220V main system with charger

GARMIN Pack 1

Autopilot, VHF, AIS
 GPS 7410
 2*multi GMI20



NAVIGARE EQUIPMENT

Windex	Seacharts (full set)	Navigare wifi system 3G/4G
Antifouling with double epoxy treatment	Navigational equipment (traveller, ruler, pen etc.)	LPG barbeque
First filling & engine service	Binoculars	
Spare fuel cannister, 5 liter	Loggbok	
	Local waters pilot	
Mooringrope 2*15 m, 2*20 m & 1*50 m	Nationality flag + Navigare flag	
Fenders * 8	Signal flags	
Baloon fender	Torch (flash light) w. spare batteries	
Gangway	Flashlight 12 volt	
DELTA anchor & Anchor connector	Mask, snorkel and fins	
Anchor chain 80 meter	Bosun`s chair	
Anchor thief	Spares; engine oil, 3 * filter, engine belt & impeller	
Hook for releaving anchor windlass + 4m rope	Toolbox with tools	
Second anchor & 10 + 2 m chain w. Schackles.		
Boat hook		
Power cord for shore supply (30 m)		
	Galley and cooking equipment	
Life raft. (RNOG)	Glas, wine glas & cups (RNOG)	
Horse shoe life bouy, holder & light	Knives, forks and spoons (RNOG)	
Rescue sling (Life sling)	Plates - big, small and deep (RNOG)	
Emergency flares	Gasol bottles * 2	
Fire extinguishers	Sheets, pillowcases, towels & kitchen towels (RNOG)	
Wire cutter	Blankets and pillows (RNOG)	
Safety harnesses + rope with hooks (RNOG / 2)	Hangers (cabins x 6)	
Lifewest (RNOG + 1 junior)		
Radar reflector	Water hose 15 m, with watergun	
Wooden plugs	Deck brush and bucket	
Fog horn	Toilet brush (nr of WC)	
First aid kit	Dustbin (nr of WC)	
	Cleaing equipment (interior)	
	Funnel, Sponge and container	