



## NAVIGARE CHARTER FLEET 2019

### Annex 1- NAUTITECH 40 OPEN - MED

#### SPECIFICATIONS

(all prices in Euro ex. VAT)

LOA (meter)  
Beam (meter)  
Draft (meter)  
Light Displacement (kg)  
Engine (Hp)  
Sail area main & furling genoa (m<sup>2</sup>)  
Cabins  
Toilettes  
Steering wheels  
Registered number of guests (RNOG)  
Diesel tank (liter)  
Water tank (liter)

#### NAUTITECH 40 OPEN

11,98  
6,91  
1,35  
8 500  
2 x 40  
91  
4  
2  
2  
8+1+1  
2 x 215  
2 x 215

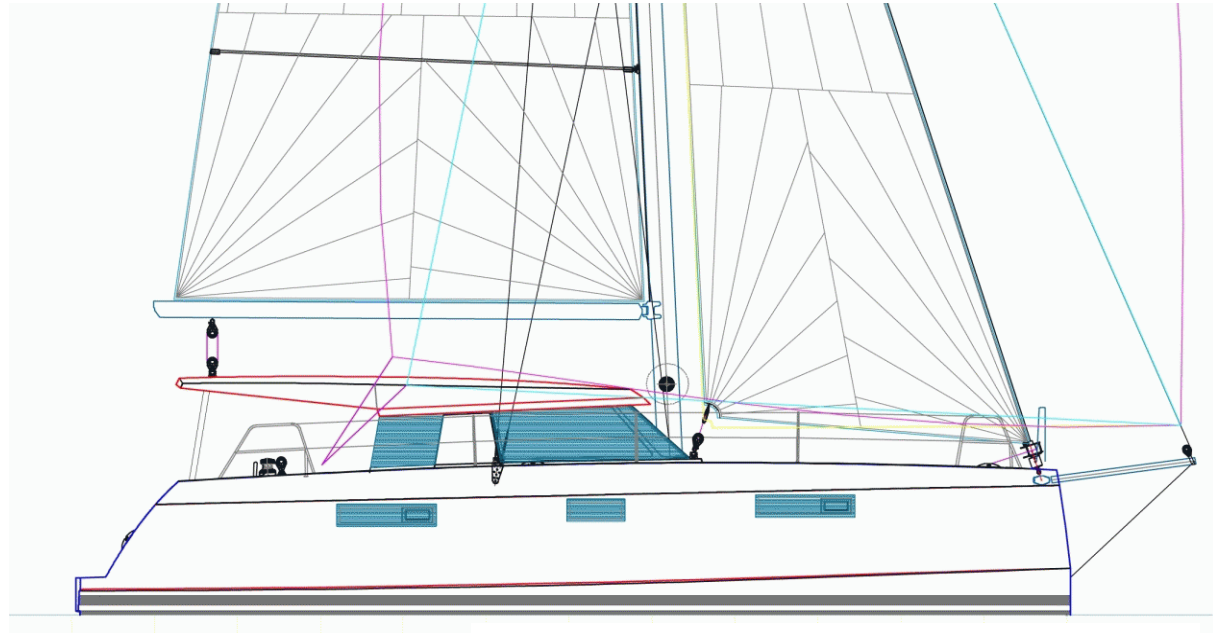

*Non contractual image. Illustrations may feature optional equipment available at additional cost.*

Commissioning - Delivery &  
Registration included





## NAUTITECH 40 OPEN

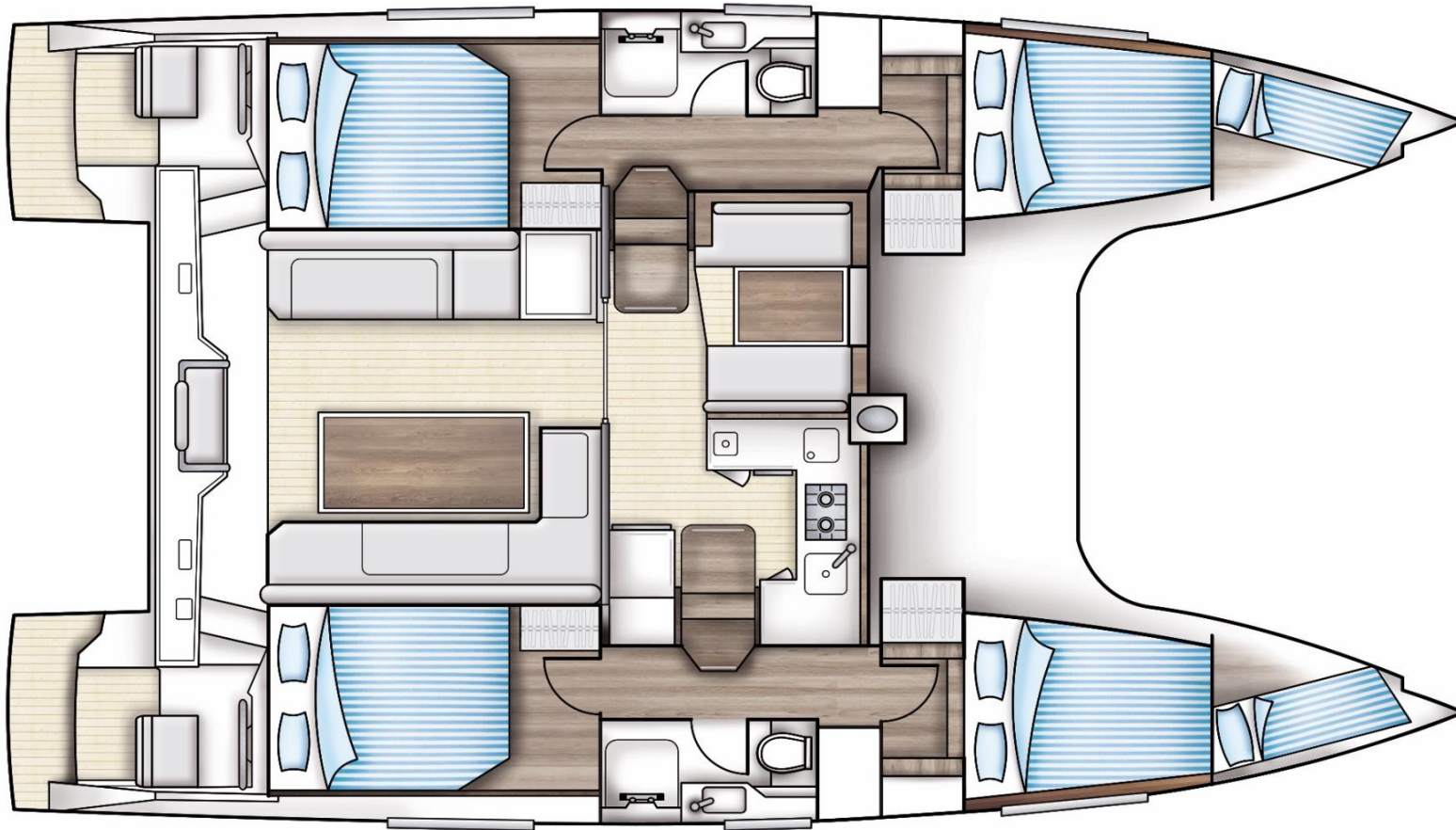

*Non contractual image. Illustrations may feature optional equipment available at additional cost.*



## YARD EQUIPMENT

### STANDARD EQUIPMENT

Hull and Deck in gelcoat white, coachroof in gelcoat light grey  
 Keel in GRP laminated and bonded to hull  
 6 x Hull windows including opening porthole  
 Aluminium deck stepped mast, anodised, with 2 spreaders sets  
 Aluminium boom, anodised  
 Anodized aluminium forward front beam  
 Running rigging  
 Mainsheet traveller on the coachroof  
 4 x Lewmar Evo alu winches 2-gear ST, 3 in cockpit, 1 at mast  
 2 x Winch handles and pockets  
 Full batten mainsail (2 reef lines), Dacron  
 Self-tacking Solent in Dacron, incl. UV protection (Grey)  
 Guardrail on hull sides with stainless steel wires  
 2 x Forward pulpits with seats in teak  
 6 x Mooring cleats, aluminium  
 Anodised aluminium forward beam with integrated anchor roller  
 Two net lashed to hull and front beam  
 Bow anchor locker and storage  
 8 x openable deck hatches (1 additional in the 3 cabin version)  
 2 x 3-blade fixed aluminium propellers  
 Two helmstand with compass and stainless wheels, leather covered  
 GRP rudders with stainless steel stock  
 Emergency tiller  
 Access to engine room via transom hatches  
 9" Digital Switching System incl.MFD at chart table for 12V System  
 Alternators 115Ah (1 x per engine)  
 1 battery per engine 12V/90Ah  
 Battery for service 1 x 12V/107Ah (gel)  
 Electrical switch for batteries (service and engines)  
 LED navigation lights and anchor light  
 Spot LED ceilinglights in cabins, bathrooms  
 Dimmable ceiling LED strips ceilinglights in saloon and cockpit  
 Electric and manual bilge pumps in both hulls  
 Electric bilge pumps in both engine compartments  
 2 x 215L freshwater tanks

Freshwatersystem with electrical pressure pump  
 Aft bench with storage  
 Double sliding door to salon  
 Teak grating over cockpit drainage  
 Large cockpit lockers  
 Aft pushpits  
 Foldable bathing ladder on starboard

### OPTIONS INCLUDED

2 x 40hp diesel engines Volvo Penta (Saildrive)  
 Synthetic-teak in cockpit and aft platforms  
 Frontdeck Lounge: Bar/storage box for front deck lounge with integrated cupholders.  
 Foldable 3 p cushions convertible into loungearea  
 Bimini on helm stand (2 x 1250)  
 Cockpit table convertible into lounge area  
 Cushions for cockpit seats and aft bench  
 Manual winch for mainsheet, Port.  
 Upholstery saloon fabric "Nautilus"  
 Starboard: Extra berth in forepeak  
 Portside: Extra berth in forepeak  
 Mosquito screens for all hatches on deck  
 12 V fans (1 per cabin/2 in saloon)  
 12V plugs (1 x per cabin and 1 x saloon)  
 FUSION Marine Audio MS-BB300 (AM/FM, USB, Bluetooth, Aux, 2 speakers in saloon and 2 speakers in cockpit)

### PACKS INCLUDED

HOLIDAY  
 Hull stripe (Grey std / white with Hull wrap option)  
 Upgrade 2 x 30hp diesel engine Volvo Penta  
 2 stainless steel handrails on coachroof  
 Davits and cleats for tender  
 Top zenital window  
 Cockpit shower with hot/cold water on Stb

### PACKS INCLUDED cont.

Upgrade mainsail with 3 reef lines  
 Lazy bag system  
 Additional storage and drawer under the seats  
 Refridgerator 130L, 12V in front galley  
 Opening porthole in aft cabins above bed heads  
 Blinds for hull windows  
 Stainless steel handrail at companionway  
 Storage space under bed (no drawer)  
 Upgrade electrical system with battery for Service 2 x 12V/107Ah (gel) incl. 32A shorepower system 230V with plugs in all cabins and battery charger 60Ah, galvanic isolator (one per hull)  
 Dimmable ceiling LED in cabins and companionways \*\*\*  
 Warm water heater via engine-cooling, 40L  
 2 integrated hatches into deckhouse windscreen  
 Mooring Kit (6 Fenders with socks, 4 mooring lines)

### NAV-PACK Cruise

2 x B&G Triton Displays (1 x per helmstation) with Speed-, Depth-, Wind-Transducer  
 B&G Autopilot, B&G Autopilot control unit (stb helmstation)  
 B&G V90 VHF incl. Antenna (nav station)  
 2 x B&G Zeus 7" Chartplotter (1 x per helmstation)  
 B&G AIS Receiver  
 B&G H50 wireless VHF unit (stb helmstation)

### ELECTRIC COMFORT PACK

Additional service batteries (2 x 107 Ah)  
 Battery charger 100 A (substitutes 60 A charger)  
 Inverter 2000 W connected to boardnet incl. switch  
 Pre-installation for washing machine and microwave

NAVIGARE YACHTING  
EXPERIENCE TOGETHER



## NAVIGARE EQUIPMENT

Windex	Seacharts (full set)	Bimini (x2)
Antifouling with double epoxy treatment	Navigational equipment (traveller, ruler, pen etc.)	Navigare wifi system 3G/4G
First filling & engine service	Binoculars	
Spare fuel cannister, 5 liter	Loggbok	
	Local waters pilot	
Mooringrope 2*15 m, 2*20 m & 1*50 m	Nationality flag + Navigare flag	
Fenders * 8	Signal flags	
Baloon fender	Torch (flash light) w. spare batteries	
Gangway	Flashlight 12 volt	
DELTA anchor & Anchor connector	Mask, snorkel and fins	
Anchor chain 80 meter	Bosun`s chair	
Anchor thief	Spares; engine oil, 3 * filter, engine belt & impeller	
Hook for releaving anchor windlass + 4m rope	Toolbox with tools	
Second anchor & 10 + 2 m chain w. Schackles.		
Boat hook		
Power cord for shore supply (30 m)		
	Galley and cooking equipment	
Life raft. (RNOG)	Glas, wine glas & cups (RNOG)	
Horse shoe life bouy, holder & light	Knives, forks and spoons (RNOG)	
Rescue sling (Life sling)	Plates - big, small and deep (RNOG)	
Emergency flares	Gasol bottles * 2	
Fire extinguishers	Sheets, pillowcases, towels & kitchen towels (RNOG)	
Wire cutter	Blankets and pillows (RNOG)	
Safety harnesses + rope with hooks (RNOG / 2)	Hangers (cabins x 6)	
Lifewest (RNOG + 1 junior)		
Radar reflector	Water hose 15 m, with watergun	
Wooden plugs	Deck brush and bucket	
Fog horn	Toilet brush (nr of WC)	
First aid kit	Dustbin (nr of WC)	
	Cleaing equipment (interior)	
	Funnel, Sponge and container	